

Linear Hybrid Stepping Motor 35BYGL

General Specifications

Step accuracy	±5%
Temperature Rise	80° C Max
Ambient Temperature Range	-20°C ~ +50°C
Insulation Resistance	100MΩ Min.500VC DC
Dielectric Strength	500V AC 1S



Electrical Specifications

Model	35BYGL402E	35BYGL401
Step Distance (mm/step)	0.01	0.01
Motor Length (mm)	34	34
Rate Voltage (V)	3.6	12
Rate Current (A)	0.8	0.5
Phase Resistance (Ω)	4.5	24
Phase Inductance (mH)	4.5	12
Holding Torque (kg.cm)	1.0	1.0
Lead Wire (NO.)	4	6
Detent Torque (g.cm)	13	13
Rotor Inertia (kg.m)	95	95
Motor Weight (kg)	0.17	0.17

Linear Hybrid Stepping Motor 35BYGL

Mechanical Dimensions

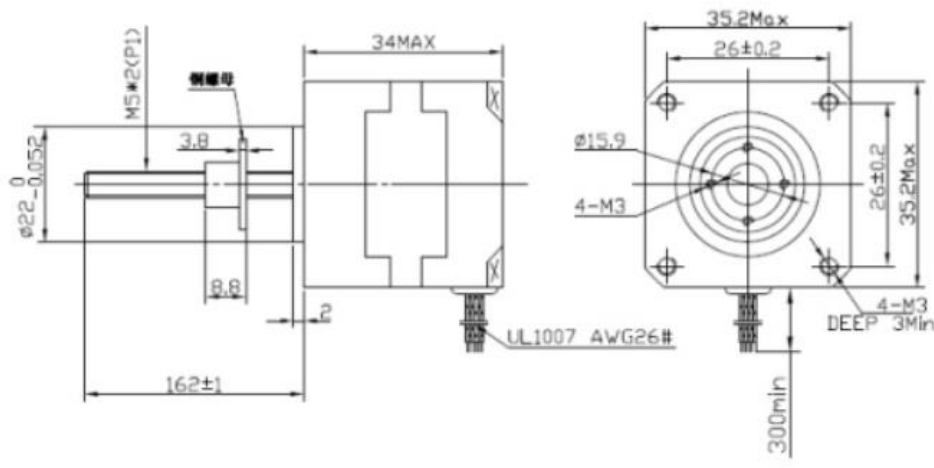

Wiring Diagram

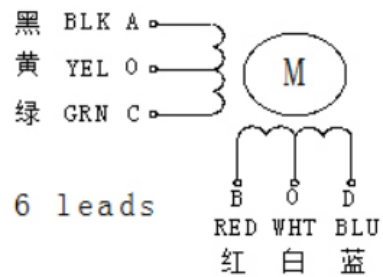
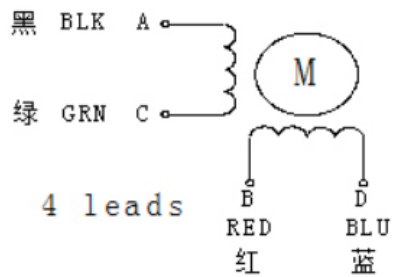

Softing Italia

Via M. Kolbe 6,

20090 Cesano Boscone (MI)

Tel: +39 02 4505171

Email: info.it@softing.com

Web: www.softingitalia.it/motors