

AM-32P Series

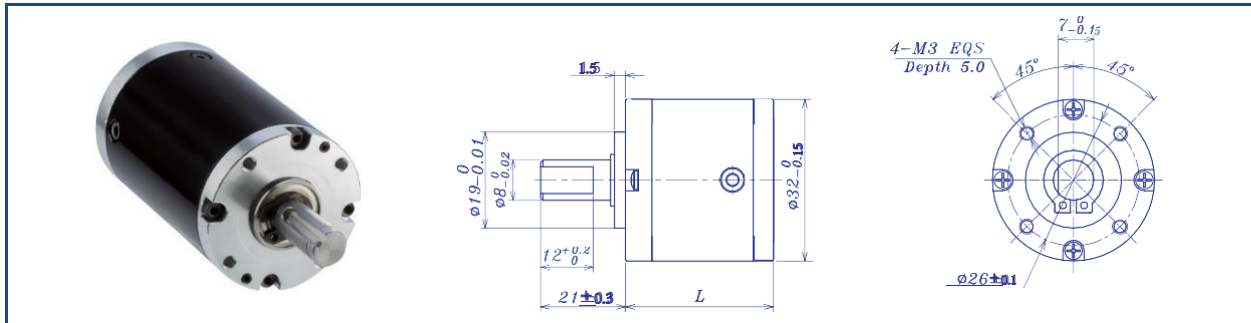

GEARBOX CHARACTER			
Gear type	Straight teeth	Average backlash on load	$\leq 2^\circ$
Output shaft	Stainless steel hardened	Radial Play	≤ 0.1
Main gear	Alloy Steel	Permissible axial load	$\leq 110N$
Ring gear	Steel	Permissible force press fits	$\leq 200N$ (5mm from mounting face)
Adapter plate	Aluminium alloy	Recommended input speed	$\leq 8000RPM$
Bearing AT output	Ball bearing	Operating temperature range	$-20^\circ C \sim +50^\circ C$
Axial play	0-0.3	Operating humidity range	10-90%RH
Directions	CW/CCW		

GEARBOX DATA				
Number of stage	1	2	3	4
Reduction ratio X:1	3.4	12 18 28	40 74 129	296 534 1016
	3.8	13 19 29	45 85 152	327 637 1136
	4.4	15 20 35	50 95 184	375 760 1304
	5.3	17 23 44	56 106 233	405 860 1556
	6.7	26	65 121 296	447 965 1975
Reduction ratio absolute	24/7	576/49 18/1 441/16	13824/343 189/2	85169/288 194481/256
	23/6	92/7 484/25 88/3	2208/49 3381/32	122452/375 7744/9
	22/5	529/36 16/118 35/1	1053/21 4851/40	234256/625 15435/16
	21/4	253/15 231/10 400/9	12167/2 1936/15	25921/64 64000/63
	20/3	230/9	5819/90 3200/21	53361/100 92000/81
			5566/75 735/4	101871/160 35200/27
		10648/125 700/3	14000/9	
		8000/27	160000/81	
Gearbox length "L" (mm)	31.2	38.7	46.2	53.7
Max. continuous torque (N.m)	1.9	2.5	3.2	3.9
Max. intermitten torque (N.m)	2.9	3.8	4.8	5.7
Gearbox efficiency	90%	81%	72%	65%
Moment of inertia range (g.cm ²)	1.5	1	1	1
Gearbox weight approx (g)	135	168	200	236
Gearbox model	AM-32PA-X-01	AM-32PB-X-01	AM-32PC-X-01	AM-32PD-X-01

AM-32P Example of combination		INPUT GEARBOX DATA	MOTOR DIMENSION
	Recommend Motor: Coreless Motor: (w/E) AM-CL2831MAN AM-CL2845MAN Brushless Motor (w/E) AM-BL2845AN	Modulus: 0.45 Press angle: 20° Teeth number: 9 12 15 18 21 Max gear hole "A": 2.0 3.0 4.0 5.0 6.0 Max motor shaft: 2.0 3.0 4.0 5.0 6.0 Motor dimension "D": 10.0 16.0	
		Recommend Encoder: Suitable for Coreless Motor Encoder S: AM-EN1611S***	
Suitable for Brushless Motor Encoder S: AM-EN1611S*** Encoder T: AM-EN2412T***			